

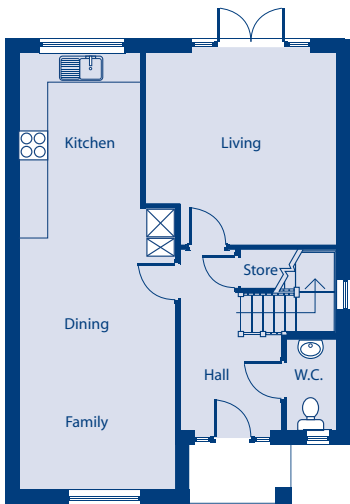

THE WREN C

4 BEDROOM DETACHED HOUSE



GROUND FLOOR

| | METRIC | IMPERIAL |
|-----------------------|-------------------|---------------------|
| Living | 3.975m* x 3.955m* | 13' 0"m* x 13' 0"m* |
| Kitchen/Dining/Family | 3.215m* x 9.065m | 10' 7"m* x 29' 9" |
| W.C. | 1.045m x 1.840m | 3' 5" x 6' 0" |

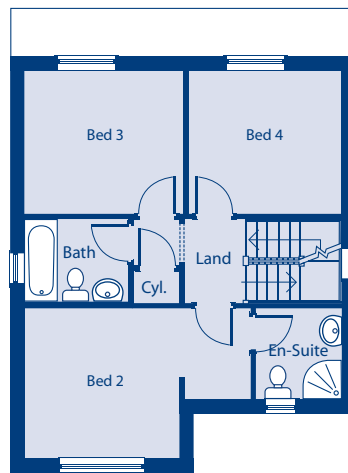

FIRST FLOOR

| | METRIC | IMPERIAL |
|-----------|-------------------|---------------------|
| Bedroom 2 | 4.725m* x 3.100m* | 15' 6"m* x 10' 2"m* |
| En-suite | 1.750m x 1.840m | 5' 9" x 6' 0" |
| Bedroom 3 | 3.325m x 2.940m | 10' 11" x 9' 8" |
| Bedroom 4 | 3.175m x 2.940m | 10' 5" x 9' 8" |
| Bathroom | 2.175m x 1.700m | 7' 2" x 5' 7" |

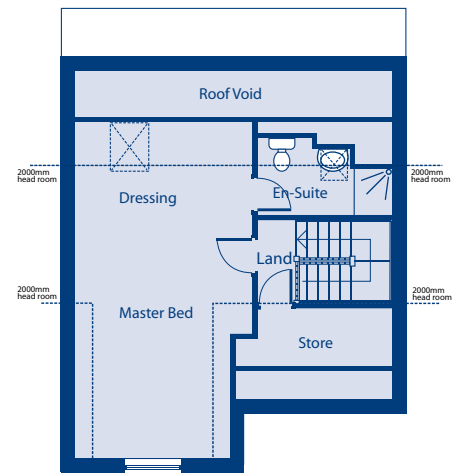

SECOND FLOOR

| | METRIC | IMPERIAL |
|----------------|------------------|--------------------|
| Master Bedroom | 3.680m* x 6.590m | 12' 1"m* x 21' 7"m |
| En-suite | 2.815m x 1.615m* | 9' 3"m* x 5' 4"m* |



Whilst every care is taken in the preparation of the information and artist impression on this leaflet, they are for guidance only. External details and finishes may vary on individual plots and from one development to another. Local authority requirements and our policy of continuous improvement may cause details to be varied. Therefore these details do not constitute any part of an offer or a contract and all dimensions are approximate. * Denotes that one or both of the given measurements is a maximum dimension. June 2013

A Move In The Right Direction



www.dorbcresthomes.co.uk