

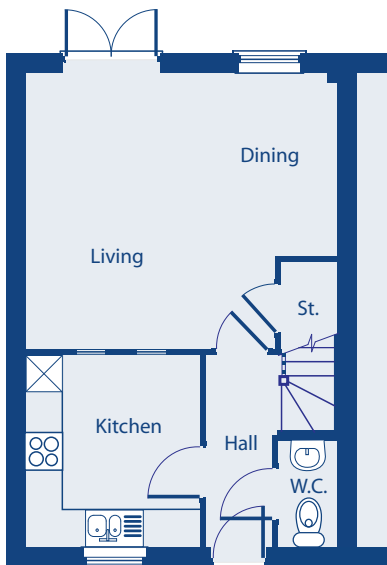

THE ASHFORD

4 BEDROOM SEMI DETACHED & TOWN HOUSES



2 Options available.
 1. Kitchen, Dining and Living as open plan.
 2. Kitchen, Dining room and separate Living room.
 Ask for details

GROUND FLOOR

	METRIC	IMPERIAL
Kitchen	2770 x 3060	9' 1" x 10' 0"
Living/Dining	4960* x 4400*	16' 3"* x 14' 5"*
W.C.	935 x 1690	3' 1" x 5' 7"

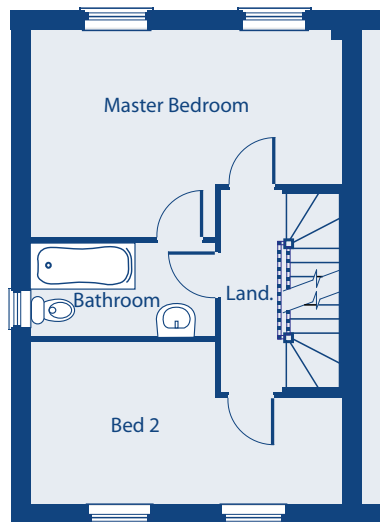

FIRST FLOOR

	METRIC	IMPERIAL
Master Bedroom	4960 x 3265*	16' 3" x 10' 9"*
Bedroom 2	4960* x 2580*	16' 3"* x 8' 6"*
Bathroom	2945 x 1480	9' 8" x 4' 10"

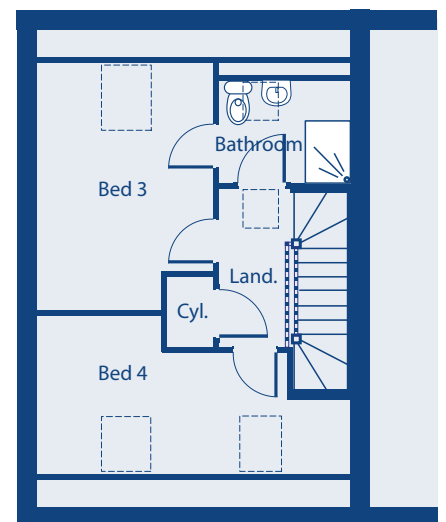

SECOND FLOOR

	METRIC	IMPERIAL
Bedroom 3	2795* x 3635*	9' 2"* x 11' 11"*
Bathroom	2075* x 1605*	6' 10"* x 5' 3"*
Bedroom 4	4960* x 2215*	16' 3"* x 7' 3"*



Whilst every care is taken in the preparation of the information and artist impression on this leaflet, they are for guidance only. External details and finishes may vary on individual plots and from one development to another. Local authority requirements and our policy of continuous improvement may cause details to be varied. Therefore these details do not constitute any part of an offer or a contract and all dimensions are approximate. * Denotes that one or both of the given measurements is a maximum dimension. September 13

A Move In The Right Direction



www.dorbcresthomes.co.uk